

## Cylinder sensor

- For pneumatic cylinders with T-shaped slot
- Metal casing
- Clamping block mounting, no pressure marks on the cylinder
- No indentations by the clamping block
- Precise readjustment
- All-electronically
- Vibration-resistant
- High protection class
- Mounting accessory available for round, pull-rod and profiled cylinders

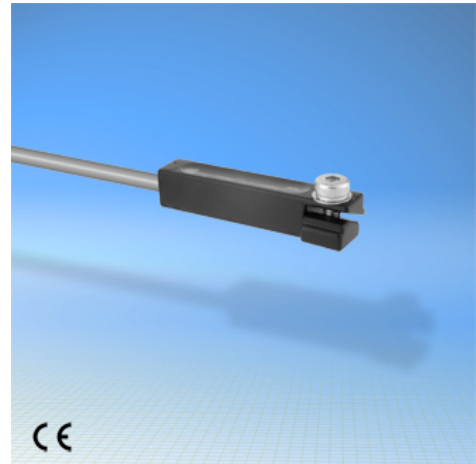

### Anschlusschema Connection diagram

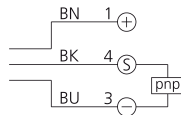

BN = Braun / brown  
BK = Schwarz / black  
BU = Blau / blue

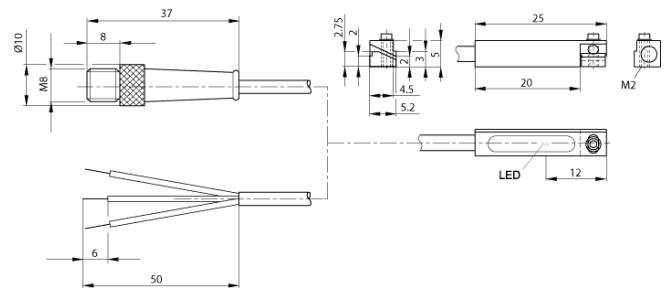

### Safety instructions

The Instruments are not to be used for safety applications, in particular applications in which safety of persons depends on proper operation of the instruments. These instruments shall exclusively be used by qualified personnel. Repair only by di-soric.

### Technical Details (typ.)

Service voltage	10 ... 30 V DC
Cylinder slot	T-shaped slot
Output	transistor pnp, NO
Maximum rating	200 mA, not short-circuit-proof, polarity-safe
Contact rating	6 W max. (30 V, 200 mA)
Internal power consumption	< 10 mA
Voltage drop	< 2,0 V
Operating frequency	1.000 Hz
Reproducibility	< 0,1 mm
Ambient temperature	-25 ... +70 °C
Insulation voltage endurance	500 V
Protection class	IP 67
Indicators	LED: yellow - output signal
Mounting	clamping block, allen screw SW 1.5 mm
Casing material	die-cast zinc
Connection	cable PUR, 2.500 mm