

MIPC XL



- Industrial approved components
- Ideal for hard environments / solid & robust
- IP65 front side
- Floating suspension between chassis & mounting / Shock and Vibration approved
- Modular system
- Front side access: Drives, Floppy, LPT, COM, Keyboard
- Easy accessibility to integrated components
- Active Fan and temperature control

TRsystems GmbH, Eglshalde 16, 78647 Trossingen, Tel.: +49 (0) 7425 228-0, Fax: +49 (0) 7425 228-34, www.trsystems.de, info@trsystems.de

Technical data

Display	38.1 mm (15.0") TFT Active Matrix, 370 cd/m ²
Resolution	1024 x 768
Touch screen	optional (resistive technology)
Slot CPU Module	starting up from Intel® Celeron® M 600 MHz to Intel® Core™2 Duo 2.2 GHz
Memory	up to 2 GByte
Hard disk	min. 40 GByte (industrial grade 24/7), optional flash disk
Drives	CD/DVD-ROM; CD/DVD-RW, floppy 1.44 MB
Standard interfaces	COM, LPT, PS/2, Ethernet 10/100 Base-T, VGA, USB
Pointing device	Touchpad or Touch
Monitoring functions	temperature, watchdog, Status LEDs
Backplane types	different versions possible (e.g.: ISA, PISA, PCI)
Pre-installed operating system	on customer's request

Electrical data

Power supply	120/ 240 VAC, optional 24 VDC
Power consumption	depends on construction

Environmental conditions

EMI	DIN EN 61000-6-2: 2006; generic standards – immunity for industrial environments
.....	DIN EN 61000-6-4: 2007; generic standards – immunity for industrial environments
Operating temperature [°C]	0 ... +50/ Intel® Pentium® 4 and Intel® Core™ Duo 2.2 GHz types 0...+45
Storage temperature [°C]	-20 ... +60
Humidity (rel. %)	90 (non condensing)

Dimension

Dimension in mm (W/H)	482.6 x 399
Cut-out size in mm (W/H)	464 x 380
Deepness in mm	195
Weight	21 kg

Customized configurations on request

MIPC XL

Drawing

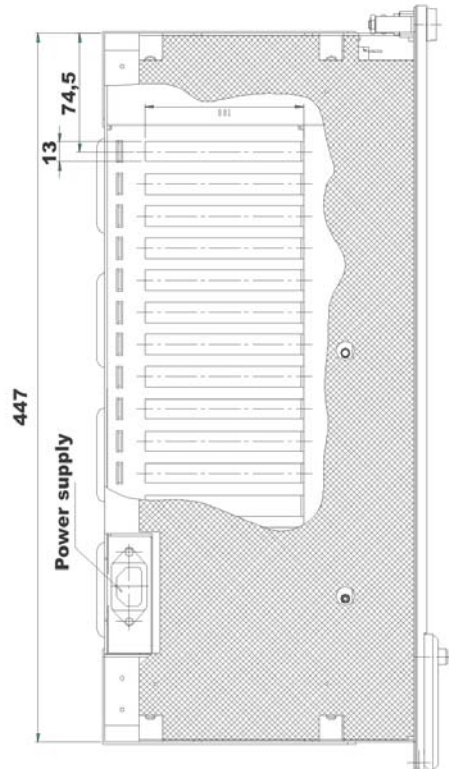
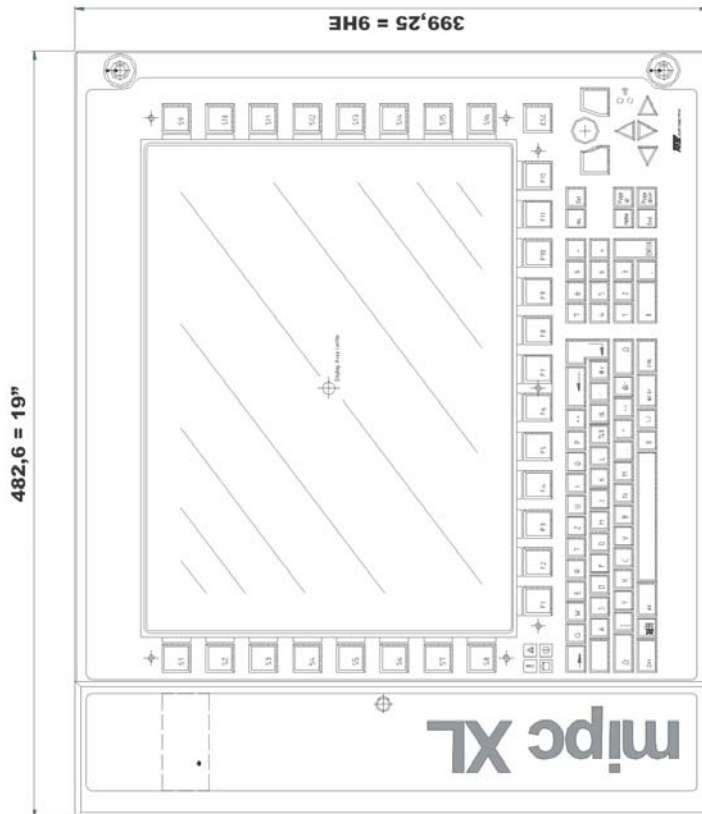
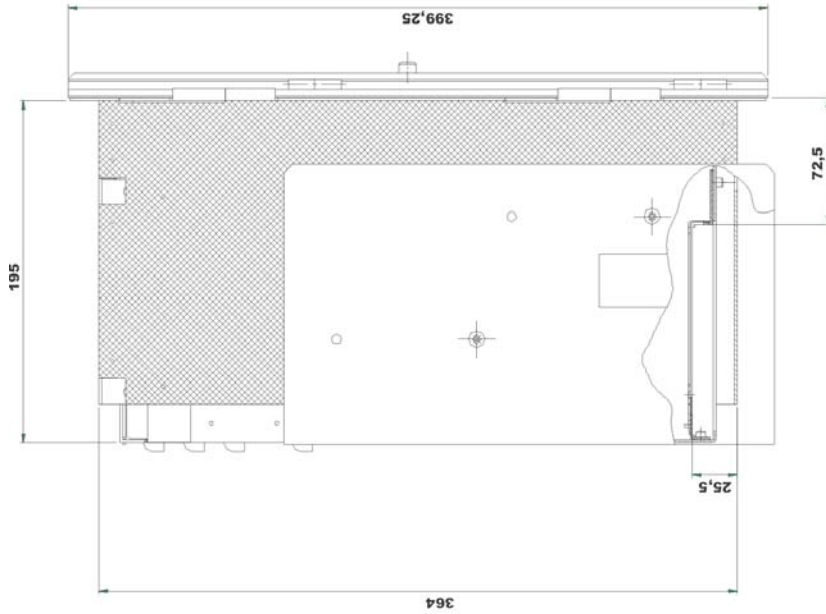

TRsystems GmbH, Eglisshalde 16, 78647 Trossingen, Tel.: +49 (0) 7425 228-0, Fax: +49 (0) 7425 228-34, www.trsystems.de, info@trsystems.de